

2 Section Detail - Handrail at Ramp
3/4"=1'-0"

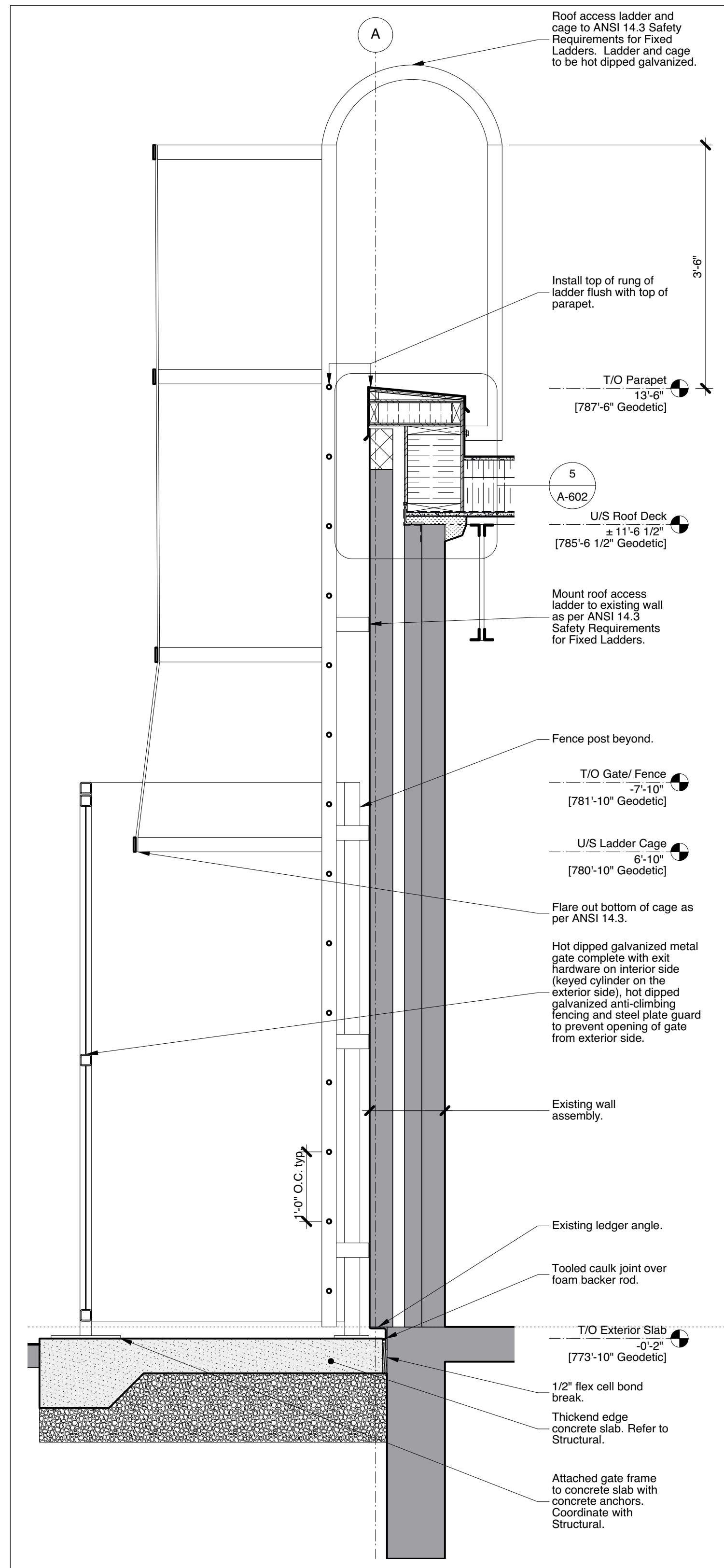

3 Wall Section - Roof Access Ladder and Gate
3/4"=1'-0"

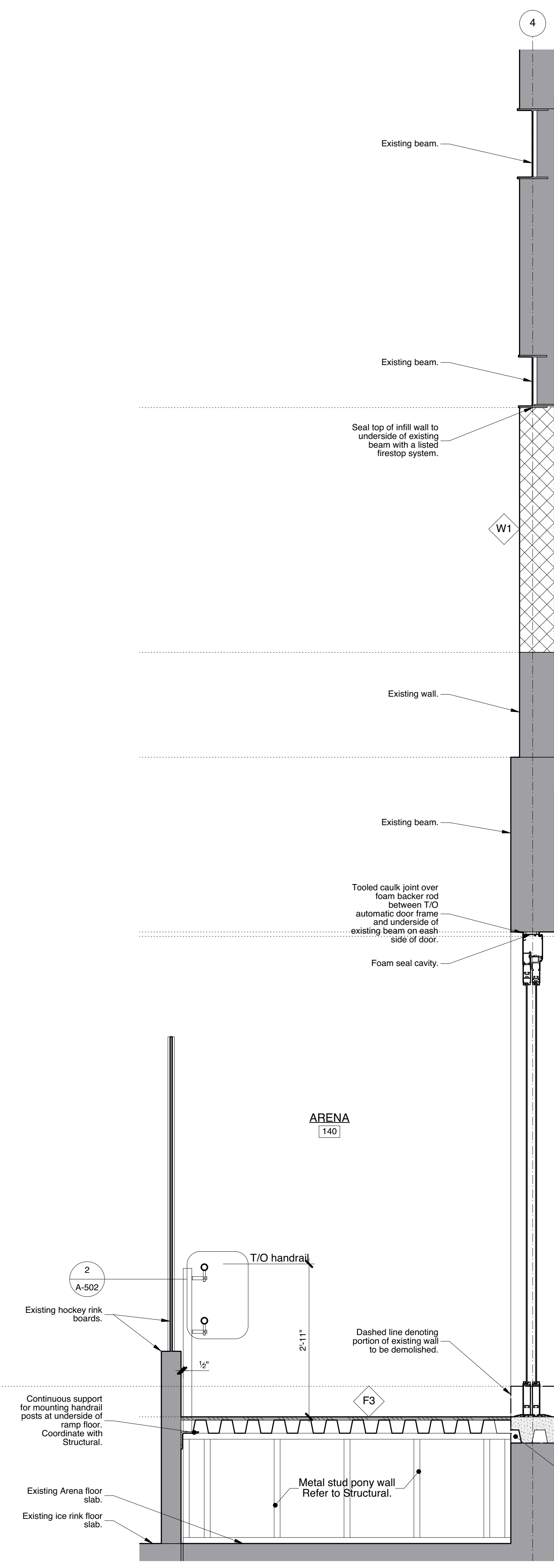

1 Wall Section - Lounge Sloped Walkway
3/4"=1'-0"

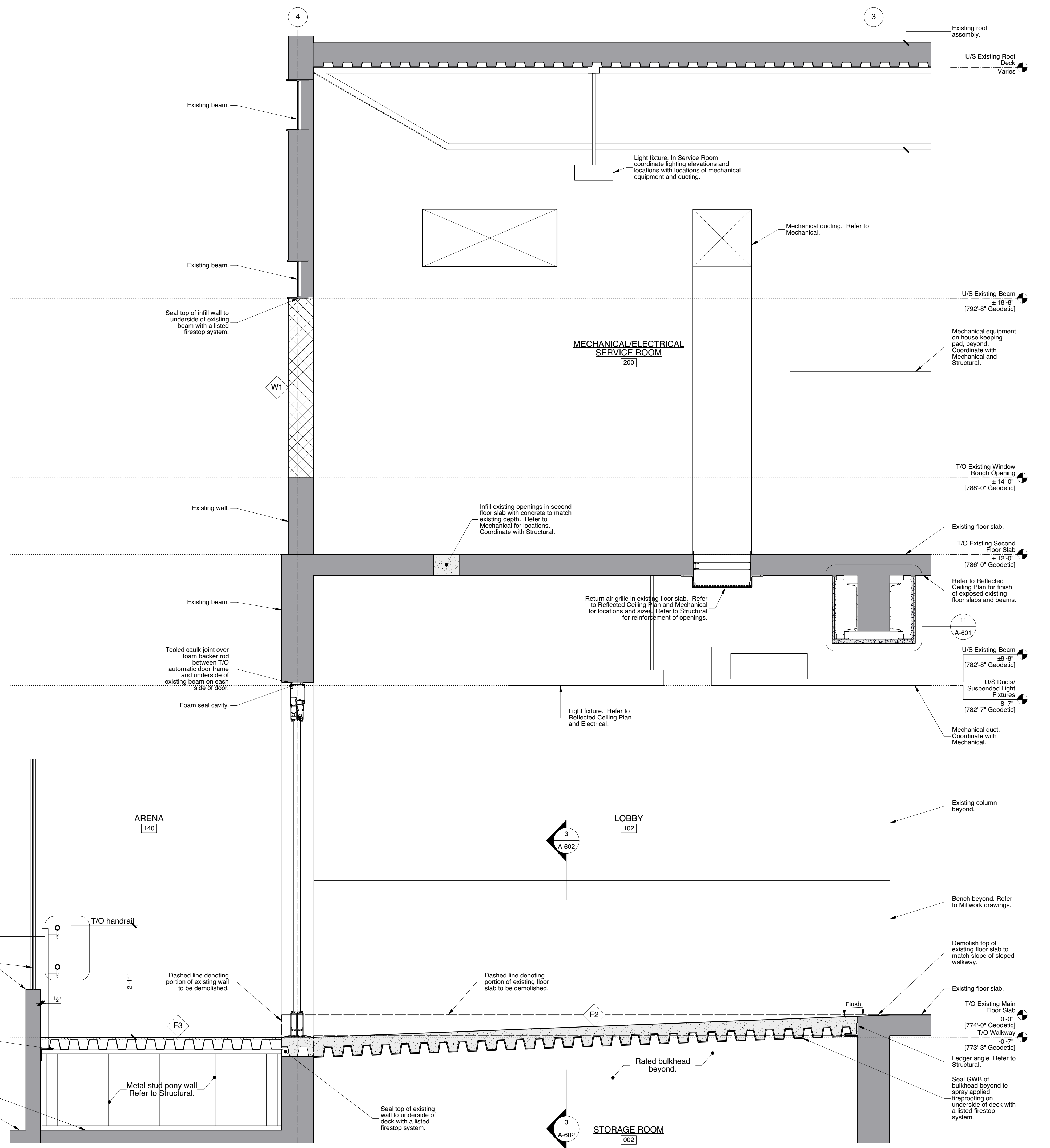

This drawing must not be scaled. The contractors shall verify all dimensions and other data on site prior to commencement of work. Discrepancies, errors, and omissions are to be reported to Public City Architecture Inc. prior to proceeding with the Work.

Drawings and specifications as instruments of service are the property of Public City Architecture Inc.; the copyright in the same being reserved.

No reproduction or revision to these drawings may be made without the permission of Public City Architecture Inc., and when made, must bear their name. All prints to be returned to Public City Architecture Inc. upon request.

Project
St. James Civic Centre
Phase 2 Building Systems
Upgrades
Drawing

Drawn By
MP
Scale
As Noted
Date
2019.07.01

Reviewed By
PS
Tender No.
1176-2019
Drawing No.
A-502